

MA 22/MA 22 D/MA 22 U

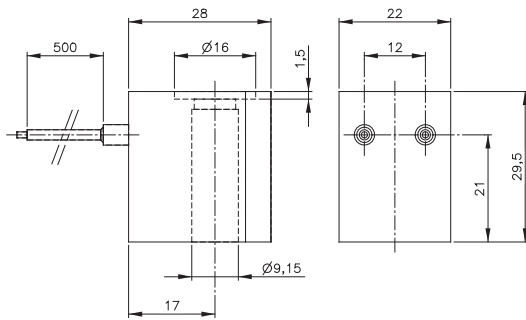

MA 22 L

AC-coils can be operated at 50 Hz and 60 Hz.  
30 mm wide coils with interface ISO 4400  
EN 175301-803-A are available on request.



22 mm wide coils for solenoid valves of MH-type,  
22 mm, 30 mm and 40 mm wide.

### MA 22

Housing made from heat resistant thermoplastic polyester material 30 % glass filled.  
Interface industryform B (DIN / ISO 436 50), connectors are displayed on page 2. 11.3.  
Equipped with appropriate connector, solenoid offers IP 65. Isolation class H.

### MA 22 L (Flying leads version)

Housing made from heat resistant thermoplastic polyester material with 30 % glass filled.  
Standard cable length of 500 mm, others are available on request. The coils are not grounded, please take national safety regulations into consideration! Isolation class H.

### MA 22 D (Epoxy version)

Housing made from Epoxy, interface industryform B (DIN/ISO 436 50).  
Equipped with connector ST 22 and ST 222 V (please refer to page 2. 11.3) solenoid system offers IP 65.  
Equipped with connector ST 22 L 500 and additional O-rings the system offers IP 67.

### MA 22 U

Same as MA 22 but with UL-certification.



| Type             | Voltage | Tolerance | Ampere | Power cons. | Connection                  |
|------------------|---------|-----------|--------|-------------|-----------------------------|
| MA 22 12 DC      | 12 V=   | ±10 %     | 250 mA | 3 W         | Industryform B (DIN 436 50) |
| MA 22 24DC       | 24 V=   | ±10 %     | 125 mA | 3 W         | Industryform B (DIN 436 50) |
| MA 22 L700 24DC  | 24 V=   | ±10 %     | 125 mA | 3 W         | Flying leads 700 mm long    |
| MA 22 48DC       | 48 V=   | ±10 %     | 62 mA  | 3 W         | Industryform B (DIN 436 50) |
| MA 22 24AC       | 24 V~   | ±10 %     | 200 mA | 5 VA        | Industryform B (DIN 436 50) |
| MA 22 110AC      | 110 V~  | ±10 %     | 45 mA  | 5 VA        | Industryform B (DIN 436 50) |
| MA 22 L500 110AC | 110 V~  | ±10 %     | 45 mA  | 5 VA        | Flying leads 500 mm long    |
| MA 22 230AC      | 230 V~  | ±10 %     | 22 mA  | 5 VA        | Industryform B (DIN 436 50) |
| MA 22 L500 230AC | 230 V~  | ±10 %     | 22 mA  | 5 VA        | Flying leads 500 mm long    |
| MA 22 D 24DC     | 24 V=   | ±10 %     | 125 mA | 3 W         | Industryform B (DIN 436 50) |
| MA 22 D 24AC     | 24 V=   | ±10 %     | 200 mA | 5 VA        | Industryform B (DIN 436 50) |
| MA 22 D 230AC    | 230 V~  | ±10 %     | 22 mA  | 5 VA        | Industryform B (DIN 436 50) |
| MA 22 U 24DC     | 24 V=   | ±10 %     | 125 mA | 3 W         | Industryform B (DIN 436 50) |
| MA 22 U 24AC     | 24 V=   | ±10 %     | 200 mA | 5 VA        | Industryform B (DIN 436 50) |
| MA 22 U 110AC    | 110 V~  | ±10 %     | 45 mA  | 5 VA        | Industryform B (DIN 436 50) |
| MA 22 U 230AC    | 230 V~  | ±10 %     | 22 mA  | 5 VA        | Industryform B (DIN 436 50) |