

1/2" NPTF Conduit Connector

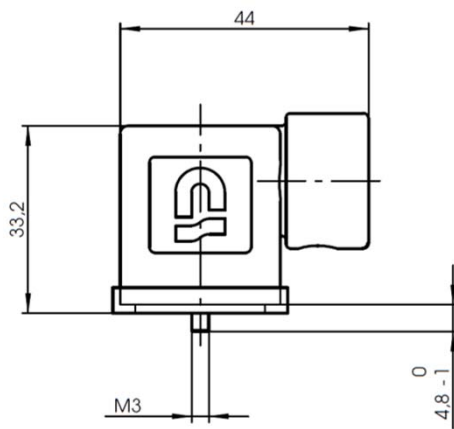

ST 22 NPTF

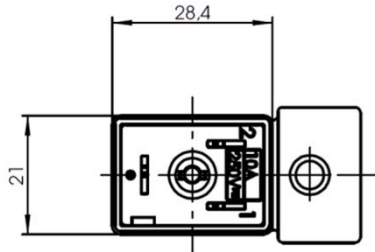

NPTF conduit connector to be used with our fully covered polyamide coil MA 22, which offers maximum protection against moisture.

Housing with 1/2" NPTF connection.

Using the enclosed profil seal and fastening screw and nut appropriately, the system reaches protection class IP 65 in accordance to IEC 60 529.

3: Central fixing screw:
M3 x 33,5 , ST37 4.8 , zinned

2: Housing:
One-piece, NPTF, black
Material: PA6 GF30

1: Terminal block:
Ground position: 12h, Poles: 2 + Ground
Material: PA6 GF30
Maximal tightening torque of contact screw: 0,2 Nm + 0,1Nm
Contacts' material: CuZn, Cu/Sn-plated
Conductor cross-section: 3 x 1 mm²
Wire installation: clamping with protecting plate
Connector is protected against wrong polarity

7: Gasket:
NBR Profil

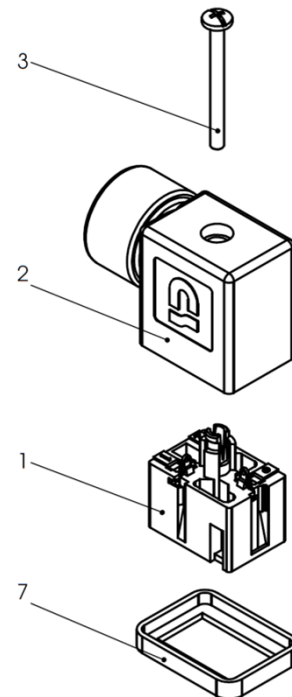

Type	Form	LED	VAR	Operat. voltage	Max. current	Available
ST 22 NPTF	Industrial	no	no	0 – 250 V	10 A	from stock