

P 310 701 VES/P 311 701 VES P 310 121 VES/P 311 121 VES

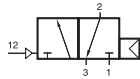

P 310 701 VES
P 310 701 VES NPT
P 310 121 VES
P 310 121 VES NPT

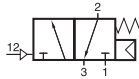

P 311 701 VES
P 311 701 VES NPT

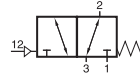

P 311 121 VES
P 311 121 VES NPT

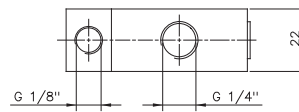
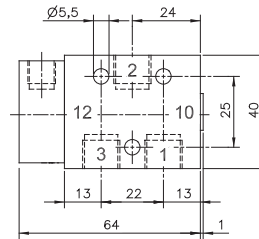

Pneumatically actuated 3/2-way spool valve.

Body parts are made from stainless steel 316L / 1.4404, seals in FKM / PUR (series 701).

Type P 310 ___ VES single pilot valve with air-spring-return.
Operating pressure and actuating pressure should be at the same level.

Type P 311 701 VES single pilot valve with combined spring return.

Type P 311 121 VES single pilot valve with mechanic spring return.

Double pilot valves are available on request.

Exhaust can be throttled.

For 1/4"-size: Due to the specific design of the internal parts pressure has to be applied to port 1. For other versions (e.g. normally open) please contact the manufacturer.

**P 310 701 VES/ P 311 701 VES
P 310 701 VES NPT/ P 311 701 VES NPT**

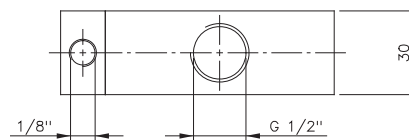
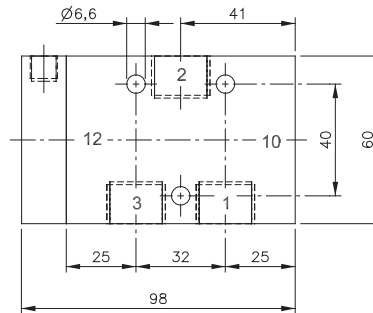

**P 310 121 VES/ P 311 121 VES
P 310 121 VES NPT/ P 311 121 VES NPT**

Type	Port size	Air flow	Operating press.	Actuating press.	Weight
P 310 701 VES	G 1/4"	1250 l/min	2 - 10 bar	the same	0,35 kg
P 311 701 VES	G 1/4"	1250 l/min	2 - 10 bar	3 - 10 bar	0,35 kg
P 310 701 VES NPT	G 1/4"	1250 l/min	2 - 10 bar	the same	0,35 kg
P 311 701 VES NPT	G 1/4"	1250 l/min	2 - 10 bar	3 - 10 bar	0,35 kg
P 310 121 VES	G 1/2"	3000 l/min	2 - 10 bar	the same	1,20 kg
P 311 121 VES	G 1/2"	3000 l/min	2 - 10 bar	3 - 10 bar	1,20 kg
P 310 121 VES NPT	G 1/2"	3000 l/min	2 - 10 bar	the same	1,20 kg
P 311 121 VES NPT	G 1/2"	3000 l/min	2 - 10 bar	3 - 10 bar	1,20 kg

P 510 701 VES/P 511 701 VES P 510 121 VES/P 511 121 VES

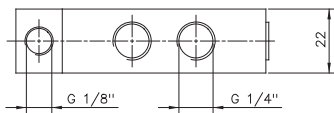
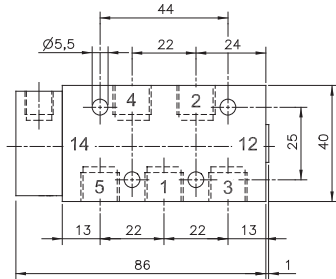
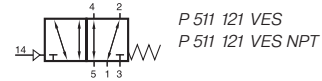
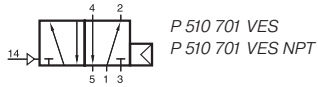

**P 510 701 VES/P 511 701 VES
P 510 701 VES NPT/P 511 701 VES NPT**

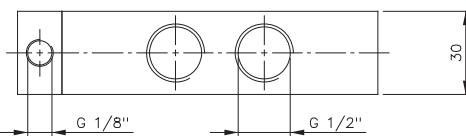
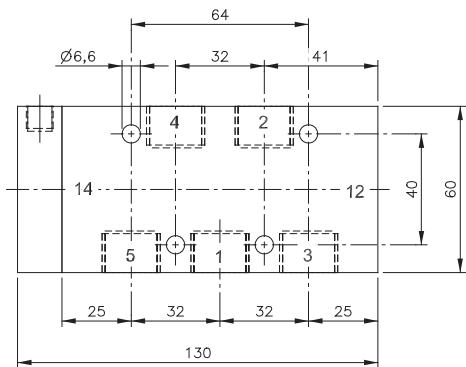

**P 510 121 VES/P 511 121 VES
P 510 121 VES NPT/P 511 121 VES NPT**

Pneumatically actuated 5/2-way spool valve.

Body parts are made from stainless steel 316L / 1.4404, rubber parts FKM, PUR (series 701).

Type P 510 __ VES single pilot valve with air-spring-return.

Operating pressure and actuating pressure should be at the same level.

Type P 511 701 VES single pilot valve with combined spring return.

Type P 511 121 VES single pilot valve with mechanic spring return.

Exhaust can be throttled.

For 1/4"-size: Due to the specific design of the internal parts pressure has to be applied to port 1. For other versions (e.g. normally open) please contact the manufacturer.

Type	Port size	Air flow	Operating press.	Actuating press.	Weight	
P 510 701 VES	G 1/4"	1250 l/min	2 - 10 bar	the same	0,40 kg	☼☼
P 511 701 VES	G 1/4"	1250 l/min	3 - 10 bar	3 - 10 bar	0,40 kg	☼
P 510 701 VES NPT	1/4" NPT	1250 l/min	2 - 10 bar	the same	0,40 kg	☼☼
P 511 701 VES NPT	1/4" NPT	1250 l/min	2 - 10 bar	3 - 10 bar	0,40 kg	☼
P 510 121 VES	G 1/2"	3000 l/min	3 - 10 bar	the same	1,50 kg	☼
P 511 121 VES	G 1/2"	3000 l/min	2 - 10 bar	3 - 10 bar	1,50 kg	
P 510 121 VES NPT	1/2" NPT	3000 l/min	3 - 10 bar	the same	1,50 kg	☼
P 511 121 VES NPT	1/2" NPT	3000 l/min	2 - 10 bar	3 - 10 bar	1,50 kg	

P 520 701 VES/P 531 701 VES/P 532 701 VES P 520 121 VES/P 531 121 VES/P 532 121 VES P 533 701 VES/P 533 121 VES

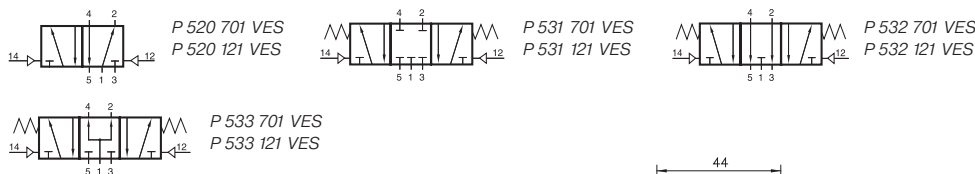

Pneumatically actuated 5/2-way and 5/3-way spool valves, actuated by impulse.

Body parts are made from stainless steel 316L / 1.4404, seals FKM / PUR (series 701).

Type P 520 __ _ VES
5/2-way double pilot. Position is kept until next pneumatic signal is applied.
Operating pressure and actuating pressure should be at the same level.

Type P 53_ 701 and 121 VES
5/3-way valves.

Type 531 centre closed
Type 532 centre exhausted
Type 533 centre pressurized

When ordering please complete the type number by 1, 2 or 3 according to the type required.

For 1/4"-size: Due to the specific design of the internal parts pressure has to be applied to port 1. For other versions please contact the manufacturer.

For type P 531 701 VES: pressure at port 1 has to be \geq pressure at 2 and 4. If pressure supply is lost, 2 or 4 can exhaust and actuator might move.

1/2" NPT on request.

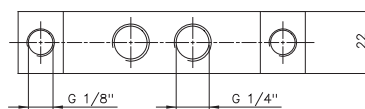
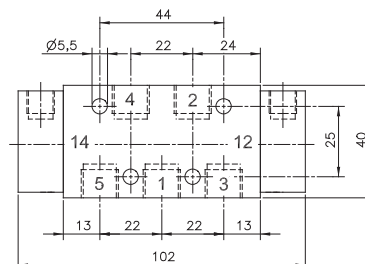

**P 520 701 VES/ P 53_ 701 VES
P 520 701 VES NPT/ P 53_ 701 VES NPT**

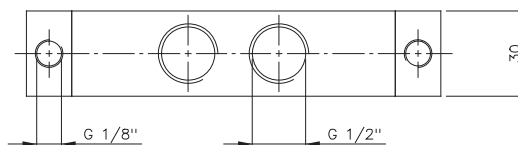
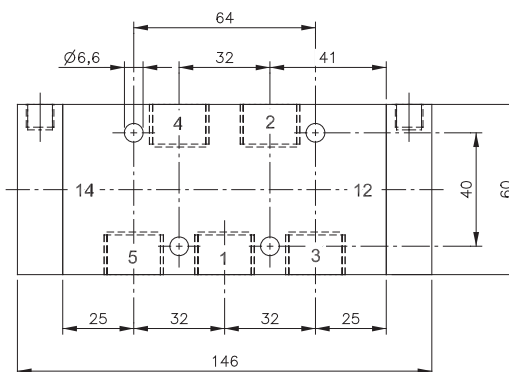

P 520 121 VES/ P 53_ 121 VES

Type	Port size	Function	Air flow	Oper. press.	Act. press.	Weight	
P 520 701 VES	G 1/4"	double pilot	1250 l/min	1,5 - 10 bar	the same	0,50 kg	☼Ex
P 520 701 VES NPT	1/4" NPT	double pilot	1250 l/min	1,5 - 10 bar	the same	0,50 kg	☼Ex
P 520 121 VES	G 1/2"	double pilot	3000 l/min	1,5 - 10 bar	the same	1,70 kg	Ex
P 53_ 701 VES	G 1/4"	5/3-way	1250 l/min	1,5 - 10 bar	3,0 - 10 bar	0,50 kg	☼Ex
P 53_ 701 VES NPT	G 1/4"	5/3-way	1250 l/min	1,5 - 10 bar	3,0 - 10 bar	0,50 kg	☼Ex
P 53_ 121 VES	G 1/2"	5/3-way	3000 l/min	1,5 - 10 bar	3,0 - 10 bar	1,70 kg	Ex